

Main Frame

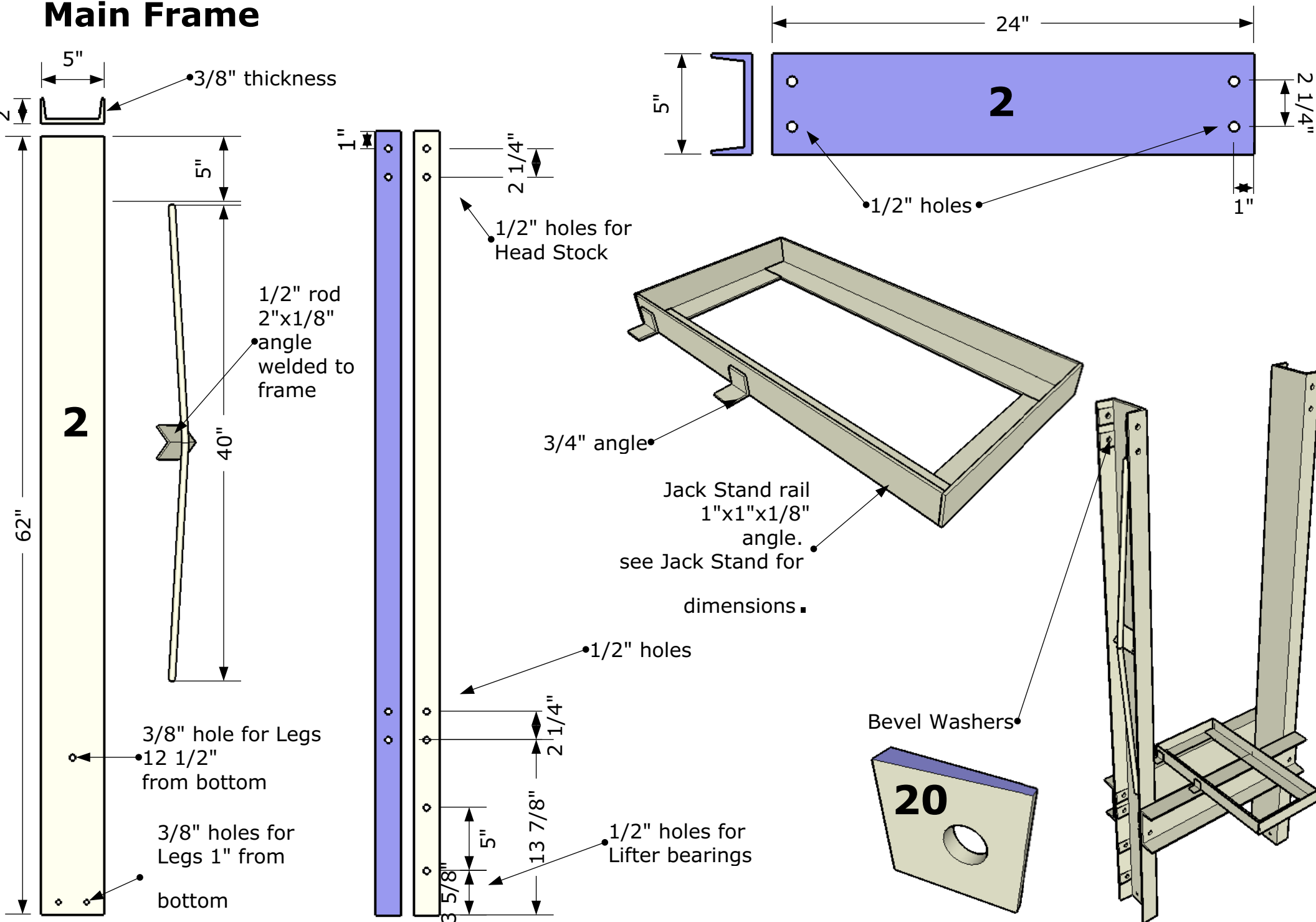

Legs and Jack Stand

20 tonne jack and stand

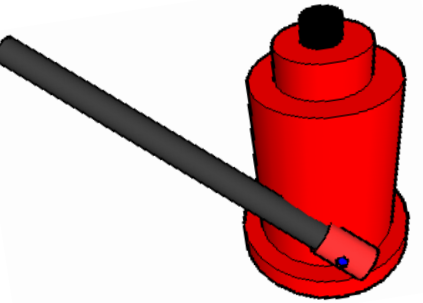

Jack stand is 5" and 5 3/4" U Channel welded.

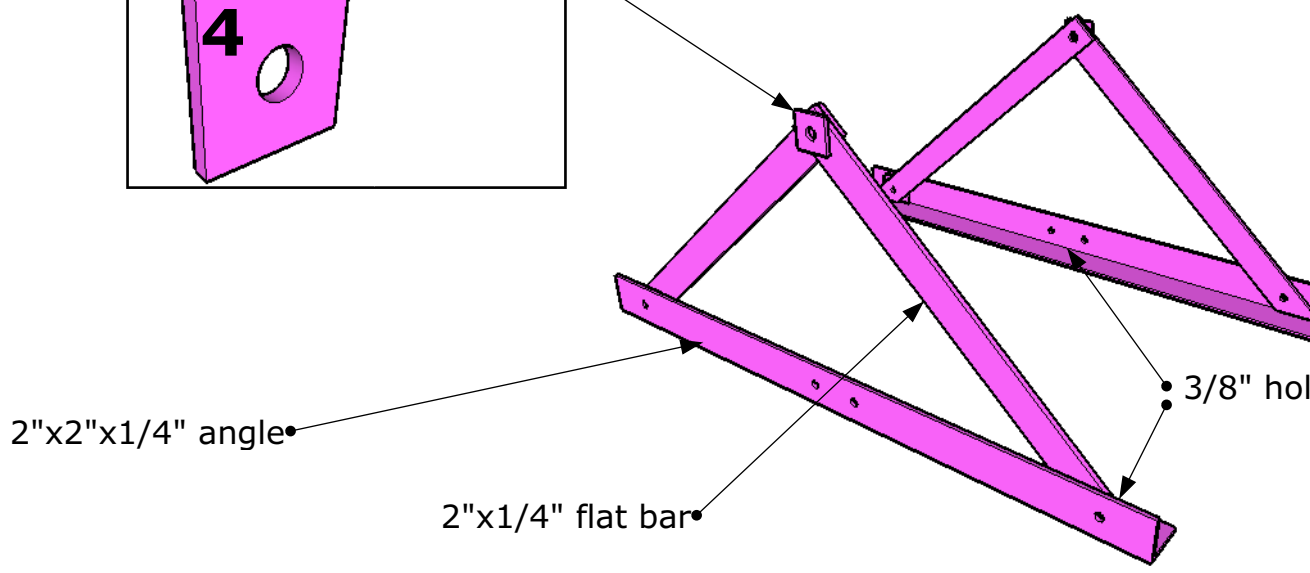
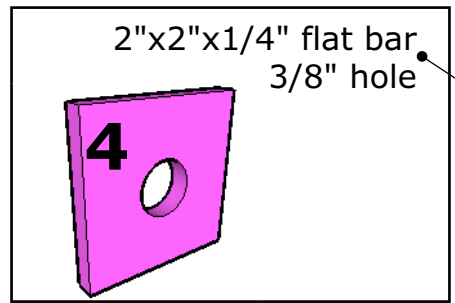
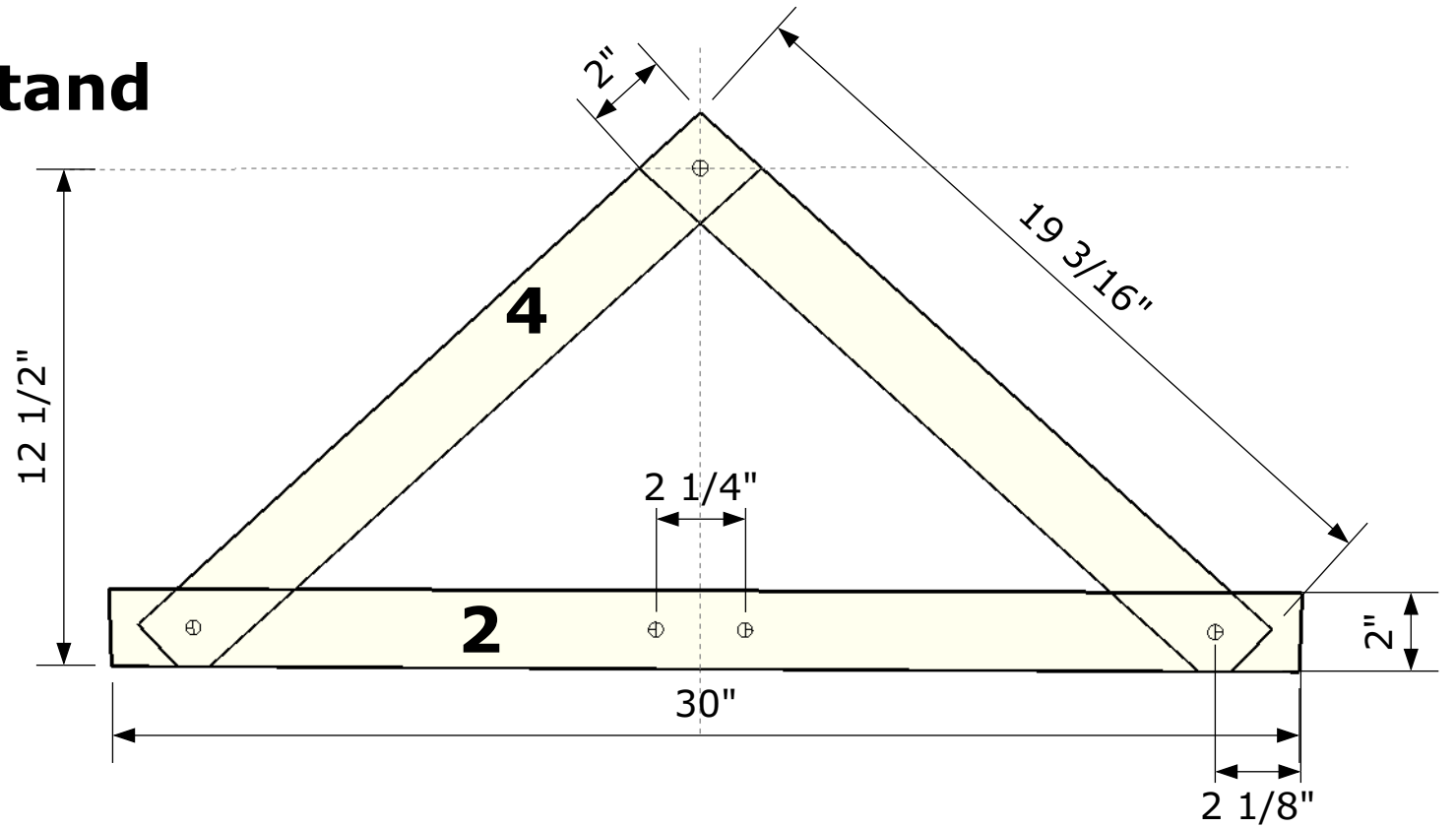
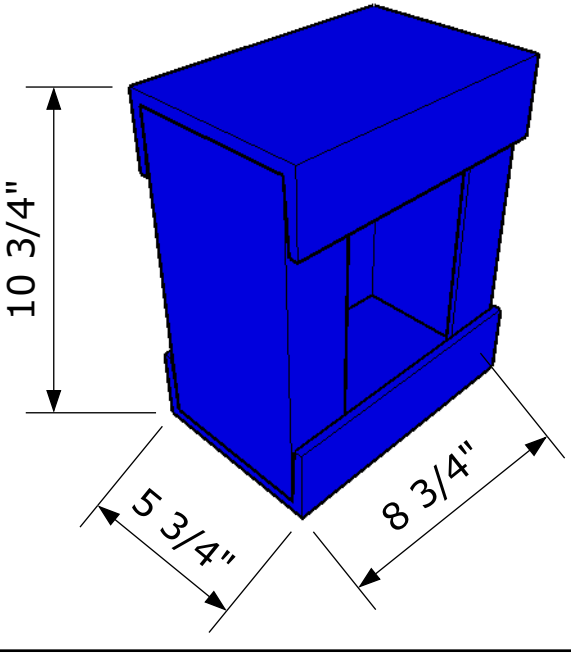

Head Stock

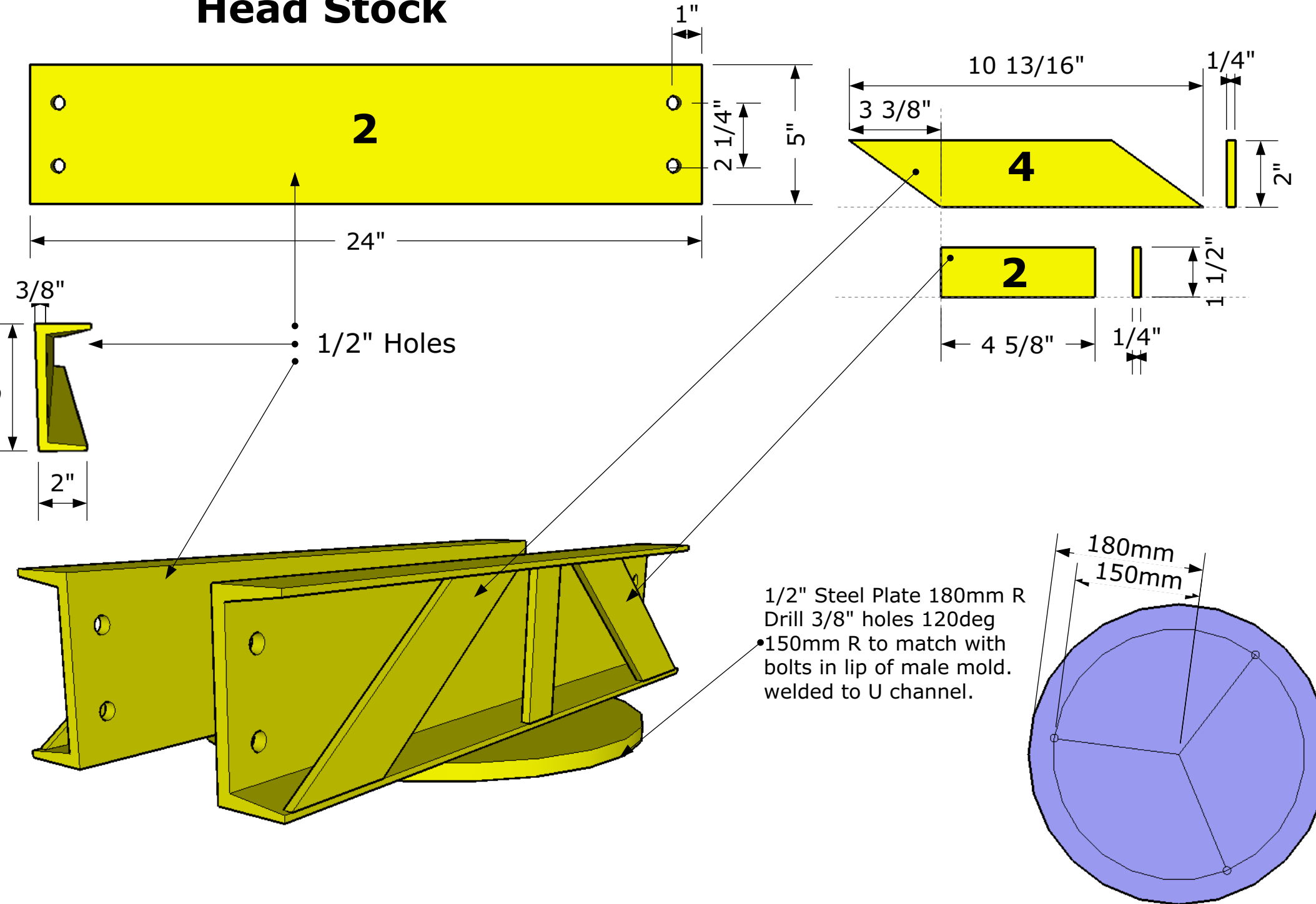

H Slide

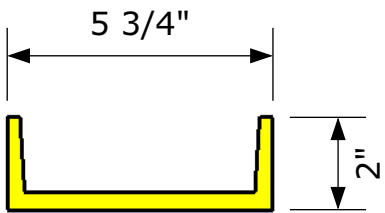

U Channel 3/8" thickness

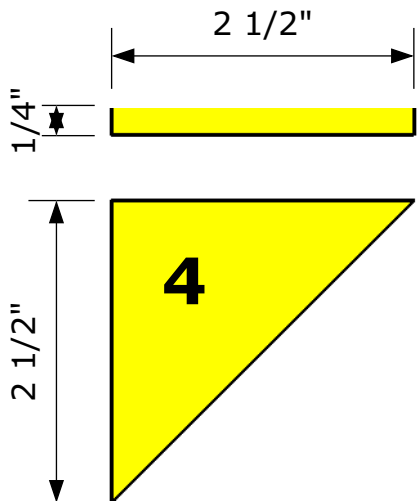

1/2" steel plate. 5/8" hole in center.

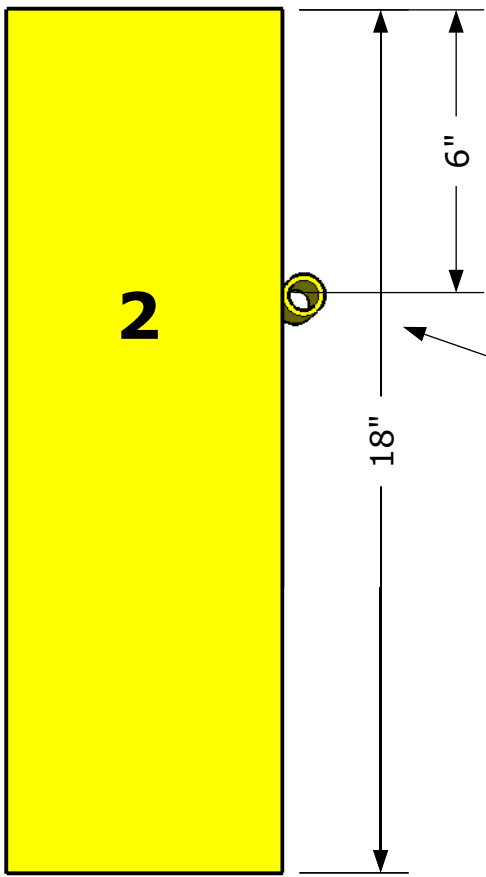
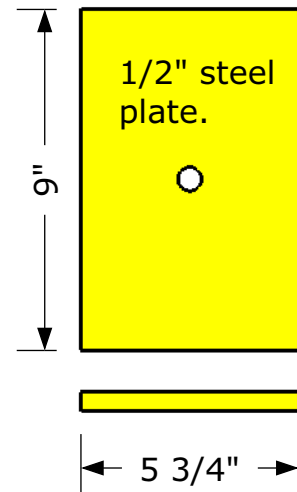
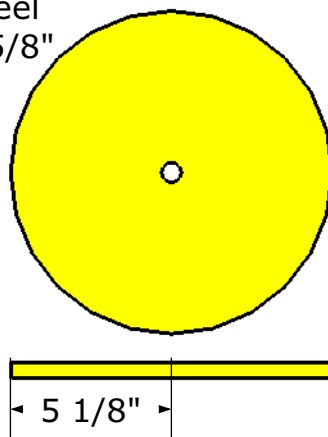

1" tubing 2" long welded to U Channel

Welded corner brace

1/2" steel plate

1/2" steel plate

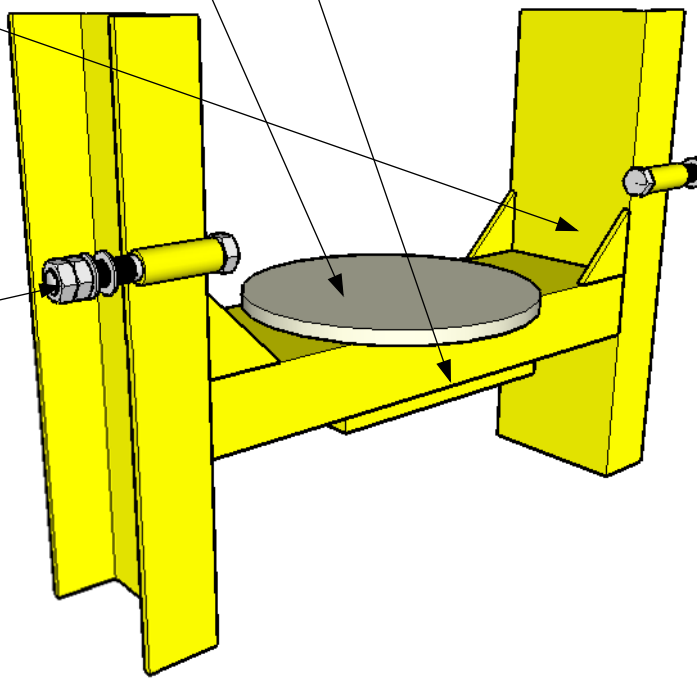
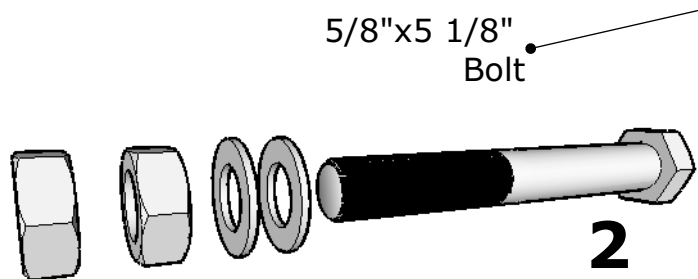

Lifter Pg1

Outer Bearing
Tubing 1/8" thick x
2" x 2" I.D to match
Inner Bearing O.D
welded to
1/4"x 7"x 2" flat bar
1/2" holes 5" apart
to match Main
Frame. See Detail
Lifter Pg2

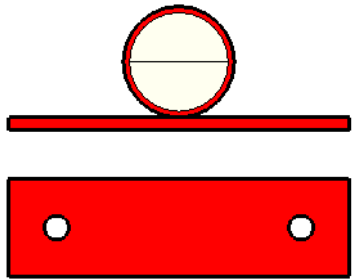

Left Lifter Arm
Upper

Left Lifter Arm
Lower

1"x1/8"x50"
Extension Bar fits
inside Lever

Axle is 1
1/4"x1/8"x24"
see detail pg2

Left Outer
Bearing

Left Inner
Bearing

Right Lifter
Arm Upper

Rigt Lifter Arm
Lower

Right Outer
Bearing

Right Inner
Bearing

1 1/4"x1/8"x12"
Lever

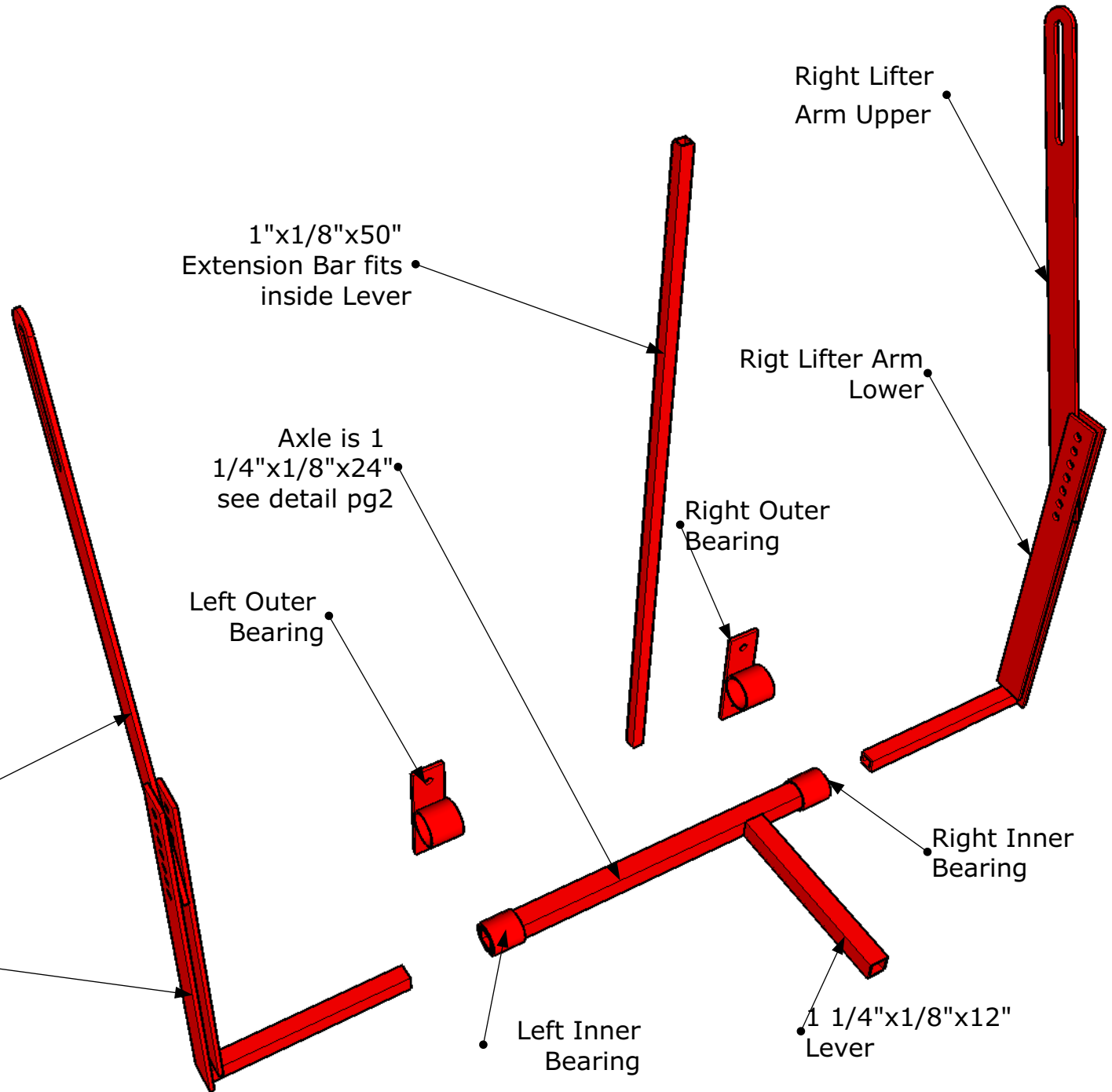

Lifter Pg2

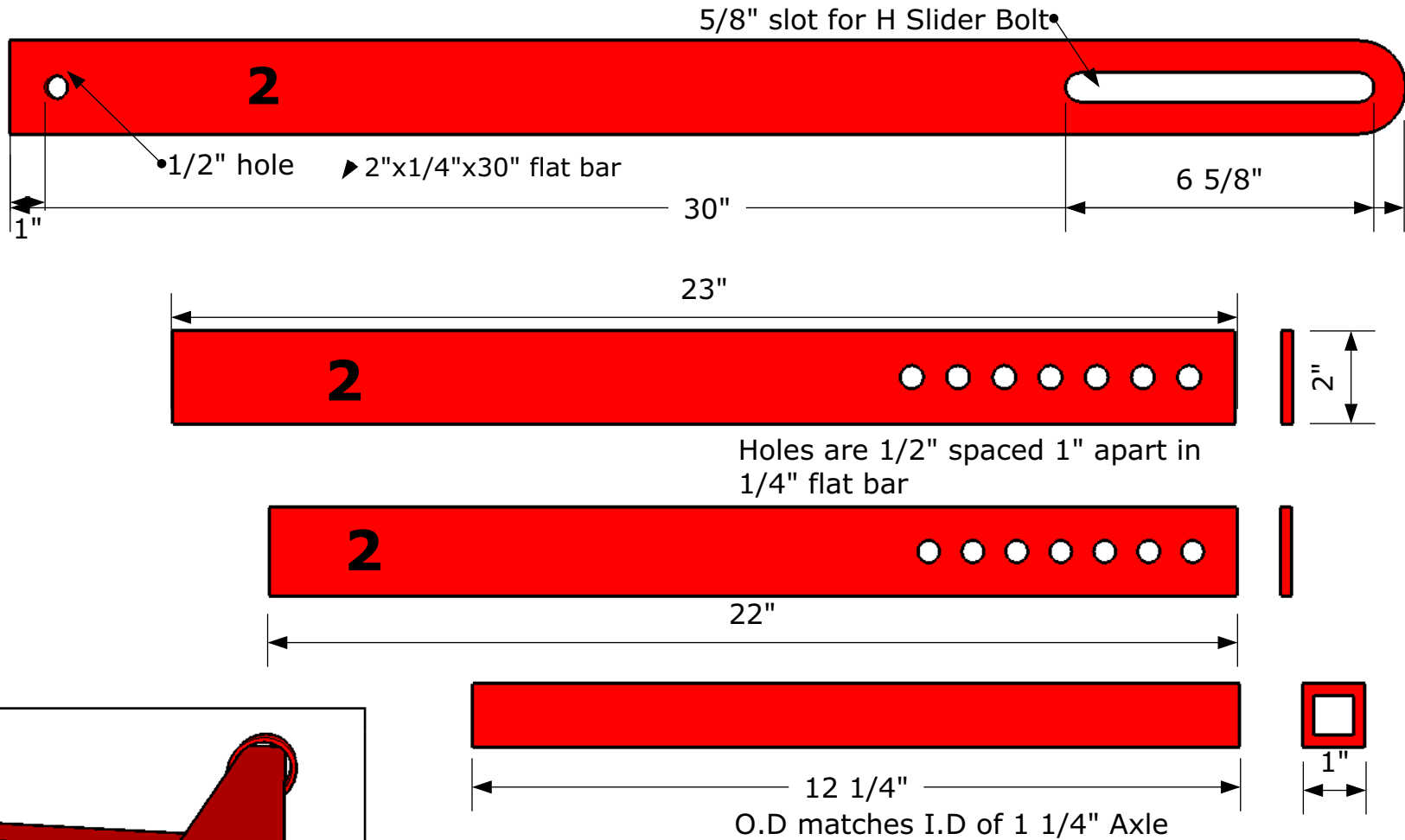
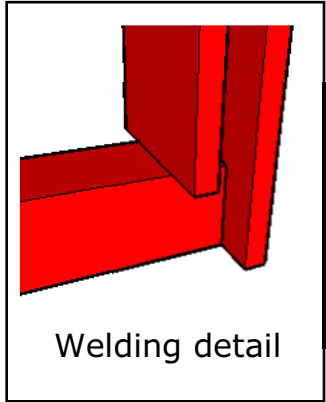

Axle and Lever

